



The Avdel DK / DL nutserts are available in steel or aluminium. Designed to provide load bearing threads in thin sheet materials.

### Key features and benefits

- Can be used in very thin sheet materials from 0.50mm (.020").
- Wide grip range provides a placing capability in material thickness ranging from 0.5 mm (.020") up to 7.9 mm (.312")
- Splined body provides increased torque-to-turn resistance over conventional non-splined inserts
- Low profile head allows near flush seating without special hole preparation
- Large flange version provides a large bearing surface which increases push-out performance
- Reduced tail end diameter offers ease of hole entry

## DK DKS

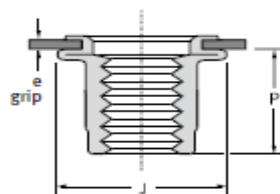
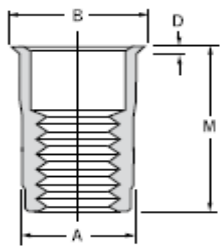

Steel  
Zinc plated  
Clear trivalent passivated



Thread / filetage / Gewinde / filetto / rosca	e (grip)		+0.15/-0	A max.	B ±0.25	D ±0.05	J max.	M ±0.38	P max.	Part No/ref
	min.	max.								
M4 x 0.7 6H	0.5	2.0	6.75	6.73	7.87	0.48	9.91	10.67	7.75	DKS-470-2.0
	2.0	3.3						11.94		DKS-470-3.3
M5 x 0.8 6H	0.5	3.3	7.60	7.52	8.64	11.43	12.07	14.86	8.00	DKS-580-3.3
	3.3	5.7								17.27
M6 x 1.0 6H	0.7	4.2	10.00	9.91	11.56	13.97	14.73	17.27	9.65	DKS-610-4.2
	4.2	6.6								20.45
M8 x 1.25 6H	0.7	3.8	13.50	13.46	15.11	0.55	18.80	17.53	11.94	DKS-8125-3.8
	3.8	7.9						20.45		DKS-8125-7.9
M10 x 1.5 6H	0.7	3.8	13.50	13.46	15.11	0.55	18.80	17.53	11.94	DKS-1015-3.8
	3.8	7.9						20.45		DKS-1015-7.9

Authorised UK distributors for:

# DL DLS

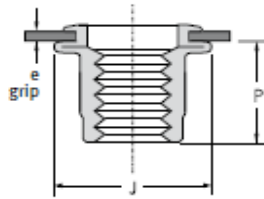
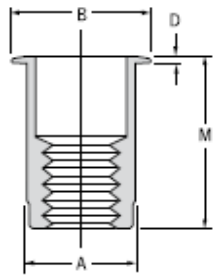

Steel  
Zinc plated  
Clear trivalent passivated

Thread / filetage / Gewinde / filetto / rosca	e (grip)		+0.15/-0	A max.	B ±0.25	D ±0.08	J max.	M ±0.38	P max.	Part No/ref
	min.	max.								
M4 x 0.7 6H	0.5	2.0	6.80	6.75	9.91	0.76	9.91	10.67	7.75	DLS-470-2.0 DLS-470-3.3
	2.0	3.3						11.94		
M5 x 0.8 6H	0.5	3.3	7.60	7.55	10.54	0.76	11.43	12.07	8.00	DLS-580-3.3 DLS-580-5.7
	3.3	5.7						14.86		
M6 x 1.0 6H	0.7	4.2	10.00	9.90	12.70	0.76	13.97	14.73	9.65	DLS-610-4.2 DLS-610-6.6
	4.2	6.6						17.27		
M8 x 1.25 6H	0.7	3.8	13.50	13.45	17.40	0.89	13.97	17.53	11.94	DLS-8125-3.8
	3.8	7.9						20.45	10.80	DLS-8125-7.9
M10 x 1.5 6H	0.7	3.8	13.50	13.45	17.40	0.89	13.97	17.53	11.94	DLS-1015-3.8
	3.8	7.9						20.45	10.80	DLS-1015-7.9

# DK DKA

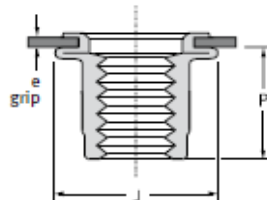
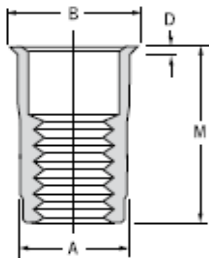

Aluminium  
Clear protective coating

Thread / filetage / Gewinde / filetto / rosca	e (grip)		+0.15/-0	A max.	B ±0.25	D ±0.05	J max.	M ±0.38	P max.	Part No/ref
	min.	max.								
M4 x 0.7 6H	0.5	2.0	6.75	6.73	7.87	0.48	9.91	10.67	7.75	DKA-470-2.0 DKA-470-3.3
	2.0	3.3						11.94		
M5 x 0.8 6H	0.5	3.3	7.60	7.52	8.64	0.48	11.43	12.07	8.00	DKA-580-3.3 DKA-580-5.7
	3.3	5.7						14.86		
M6 x 1.0 6H	0.7	4.2	10.00	9.91	11.56	0.48	13.97	14.73	9.65	DKA-610-4.2 DKA-610-6.6
	4.2	6.6						17.27		
M8 x 1.25 6H	0.7	3.8	13.50	13.46	15.11	0.55	18.80	17.53	11.94	DKA-8125-3.8 DKA-8125-7.9
	3.8	7.9						20.45		
M10 x 1.5 6H	0.7	3.8	13.50	13.46	15.11	0.55	18.80	17.53	11.94	DKA-1015-3.8 DKA-1015-7.9
	3.8	7.9						20.45		

Authorised UK distributors for:

Avdel southco

BBA

DEJOND

GESIPA

EJOT

# DL DLA

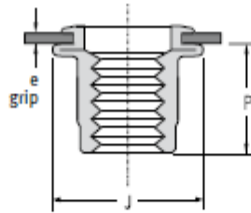
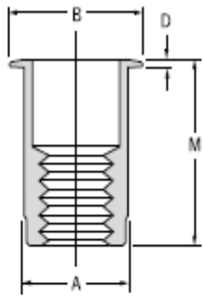

Aluminium  
Clear protective coating

Thread / filetage / Gewinde / filetto / rosca	e (grip)		 +0.15/-0	A	B	D	J	M	P	Part No/ref
	min.	max.		max.	±0.25	±0.08	max.	±0.38	max.	
M4 x 0.7 6H	0.5	2.0	6.80	6.75	9.91	0.76	9.91	10.67	7.75	DLA-470-2.0
	2.0	3.3						11.94		
M5 x 0.8 6H	0.5	3.3	7.60	7.55	10.54	0.76	11.43	12.07	8.00	DLA-580-3.3
	3.3	5.7						14.86		
M6 x 1.0 6H	0.7	4.2	10.00	9.90	12.70	0.76	11.43	14.73	9.65	DLA-610-4.2
	4.2	6.6						17.27		
M8 x 1.25 6H	0.7	3.8	13.50	13.45	17.40	0.89	13.97	17.53	11.94	DLA-8125-3.8
	3.8	7.9						20.45	10.80	DLA-8125-7.9
M10 x 1.5 6H	0.7	3.8	13.50	13.45	17.40	0.89	13.97	17.53	11.94	DLA-1015-3.8
	3.8	7.9						20.45	10.80	DLA-1015-7.9

Authorised UK distributors for:

 Avdel southco

 BBA  
www.bbafasteners.com

 DEJOND

 GESIPA

 EJOT