

Avdel® Eurosert®

The Avdel Eurosert® threaded insert is designed to provide load bearing threads in thin sheet materials. The splined body gives the insert high torque-to-turn resistance in softer materials whilst the large flange head provides a greater load bearing surface and reinforces the hole to prevent push out

Key features and benefits

- Can be used in very thin sheet materials from 0.25mm (0.01")
- Double diameter body and lead-in chamfer provide easy insertion into hole
- Access needed from only one side of the application, for high speed assembly
- Provide a female thread in application
- Can be installed in pre-coated or post painted applications without damaging the surface
- Clamp two or more sheets
- Various platings available to increase corrosion resistance
- Splined body improves torque-to-turn by up to 50% in soft materials compared to plain body inserts and improve electrical continuity in sheet metal fixings
- Low profile head allows near flush fit to application and clamps two or more sheets of material together, within the grip range
- Large flange head provides a load bearing surface and reinforces the hole to prevent push-out. Can be used as a spacer and can be supplied with an underhead seal.
- Can be used with hand tools, pneumatic tools and fully automated machines to suit a wide range of assembly methods



The Avdel Eurosert® is available in a low profile or large flange head form. Available in sizes M3 – 10 and manufactured in steel and stainless steel.

Eurosert® 39006

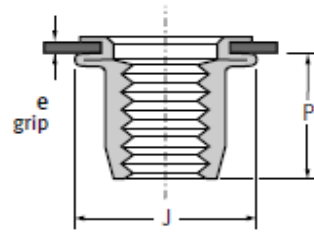
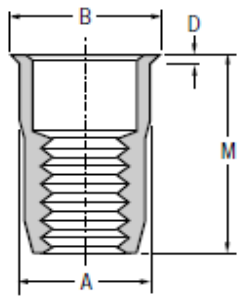

Low carbon steel*

Zinc plated
Clear trivalent passivated

ø	e (grip)		+0.1/-0	A max.	B max.	D ±0.13	J max.	M nom.	P max.	Part No/ref
	min.	max.								
M4 x 0.7	0.25	2.00	6.00	5.97	6.70	0.46	8.80	11.30	7.10	39006-74020
M5 x 0.8	0.25	3.00	7.00	6.97	7.80	0.46	10.20	12.70	7.90	39006-75030
M6 x 1.0	0.50	3.00	9.00	8.97	10.20	0.50	12.70	15.30	9.40	39006-76030
	3.00	5.50						17.80		39006-76055
M8 x 1.25	0.50	3.50	11.00	10.97	12.20	0.63	15.00	17.30	11.00	39006-78035
	3.50	6.00						19.80		39006-78060
M10 x 1.5	1.0	3.5	13.00	12.97	14.20	0.63	17.50	20.40	14.50	39006-70035

Eurosert® 9408

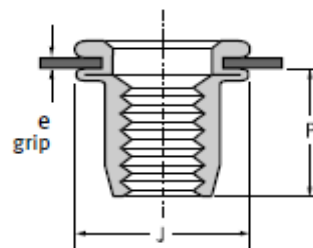
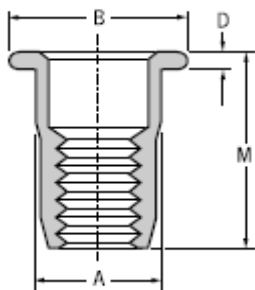

Large flange

Low carbon steel*

Zinc plated
Clear trivalent passivated

ø	e (grip)		+0.1/-0	A max.	B max.	D ±0.13	J max.	M nom.	P max.	Part No/ref
	min.	max.								
M3 x 0.5	0.25	2.00	5.00	4.95	8.20	0.75	7.40	10.50	6.00	09408-72314
M4 x 0.7	0.25	3.00	6.00	5.95	9.20	0.75	8.80	11.50	7.10	09408-72415
	3.00	4.50						13.00		09408-72417
M5 x 0.8	0.25	3.00	7.00	6.95	10.20	1.00	10.20	13.00	7.90	09408-72517
	3.00	5.50						15.50		09408-72520
M6 x 1.0	0.50	3.00	9.00	8.95	13.20	1.50	12.70	16.00	9.40	09408-72621
	3.00	5.50						18.50		09408-72623
M8 x 1.25	0.50	3.00	11.00	10.95	16.40	1.50	15.00	17.50	11.00	09408-72822
	3.00	5.50						20.00		09408-72825
M10 x 1.5	0.50	3.50	13.00	12.95	18.90	2.25	17.50	22.00	14.50	09408-72028
	3.50	6.00						25.00		09408-72031

Authorised UK distributors for:

Avdel southco

BBA



DEJOND

GESIPA

EJOT

Eurosert® 39002

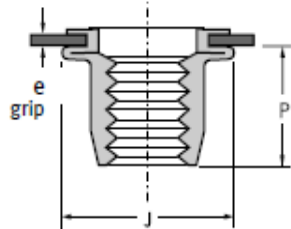
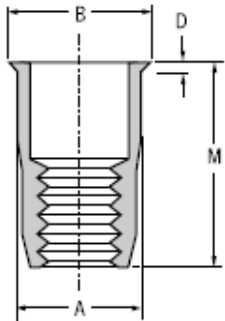

Stainless steel*
Natural

ø	e (grip)		 +0.1/-0	A	B	D	J	M	P	Part No/ref
	min.	max.		max.	max.	max.	max.	max.	max.	
M4 x 0.7	0.25	3.00	6.0	5.95	6.70	0.46	8.80	11.30	7.10	39002-24030
M5 x 0.8	0.25	3.00	7.0	6.95	7.80	0.46	10.20	12.70	7.90	39002-25030

Authorised UK distributors for:

 Avdel southco®

 BBA
www.bbafasteners.com

 DEJOND

 GESIPA®

 EJOT®