

## Avdel® Chobert®

The Avdel Chobert® speed fastener has been an important part of Avdel since the 1930's when it was used in the renowned Spitfire. The Chobert Speed Fastening® system provides consistent controlled clamp, ideal for soft or brittle materials. The light clamp of the Chobert rivet makes it ideal for use as a pivot pin or hose tail.

### Key features and benefits

- Internally tapered bore ensures consistent light clamp to reduce potential damage to soft or brittle materials
- Expands radially during installation to ensure maximum hole fill
- Lower in-place costs than welding or nail rivets
- Ideal pivot pin or hose tail
- Hot tin dipped brass option for ease of soldering and good electrical continuity
- Placed using a unique repetition mandrel system for high speed assembly
- Can be bowl fed for larger volume applications using automated equipment



The Avdel Chobert® fastener is available in aluminium, steel and brass, in dome, 120° countersunk and low profile head forms. They are available in 2.4 – 6.4 millimeter diameters.

Authorised UK distributors for:

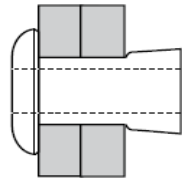
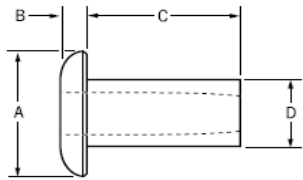

# Chobert® 1131



Dome head

Aluminium alloy\*  
(3.5 % Mg)  
Natural



ø					A	B	C	D		Fasteners per pod/ Nombre de rivets par chargeur / Niete pro Magazin/ Rivetti per carica- tore / Uds./carga	Part No/ref		
	nom.	min.	max.	min.								max.	± 0.3
2.4 (3/32")	0.00	1.57	2.49	2.55	4.0	1.0	3.17	2.48	0.5	73	01131-00304		
	1.57	3.17									4.75	52	01131-00306
	3.17	4.75									6.35	41	01131-00308
	4.75	6.35									7.92	33	01131-00310
	6.35	7.92									9.52	28	01131-00312
	7.92	9.52									11.10	24	01131-00314
	9.52	11.10									12.70	22	01131-00316
3.2 (1/8")	0.00	1.57	3.28	3.34	5.2	1.2	3.17	3.27	0.8	71	01131-00404		
	1.57	3.17									4.75	51	01131-00406
	3.17	4.75									6.35	39	01131-00408
	4.75	6.35									7.92	32	01131-00410
	6.35	7.92									9.52	27	01131-00412
4.0 (5/32")	1.57	3.17	4.09	4.16	6.2	1.5	4.75	4.06	1.6	47	01131-00506		
	3.17	4.75									6.35	38	01131-00508
	4.75	6.35									7.92	31	01131-00510
	6.35	7.92									9.52	27	01131-00512
	7.92	9.52									11.10	23	01131-00514
	9.52	11.10									12.70	21	01131-00516
4.8 (3/16")	0.00	1.57	4.85	4.93	8.6	1.8	3.96	4.82	2.0	50	01131-00605		
	1.57	3.17									5.56	38	01131-00607
	3.17	4.75									7.14	33	01131-00609
	4.75	6.35									8.74	28	01131-00611
	6.35	7.92									10.31	24	01131-00613
	7.92	9.52									11.91	21	01131-00615
	9.52	11.10									13.49	19	01131-00617
	11.10	12.70									15.09	17	01131-00619
	3.17	4.75									7.14	32	01131-00809
4.75	6.35	8.74	27	01131-00811									
6.35	7.92	10.31	24	01131-00813									
7.92	9.52	11.91	21	01131-00815									
9.52	11.10	13.49	19	01131-00817									
11.10	12.70	15.09	17	01131-00819									
12.70	14.27	16.66	16	01131-00821									
14.27	15.87	18.26	14	01131-00823									
15.87	17.45	19.84	13	01131-00825									

Authorised UK distributors for:

 Avdel southco®

 BBA

 DEJOND

 GESIPA®

 EJOT®

# Chobert® 1121

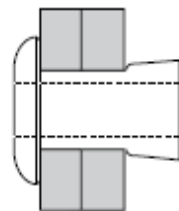
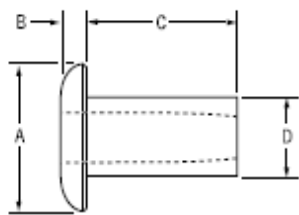



Dome head

Low carbon steel\*

Zinc plated

Clear trivalent passivated

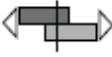

ø					A	B	C	D		Fasteners per pod/ Nombre de rivets par chargeur / Niete pro Magazin/ Rivetti per carica- tore / Uds./carga	Part No/ref	
	nom.	min.	max.	min.								max.
3.2 (1/8")	0.00	1.57	3.26	3.34	5.2	1.2	3.2	3.25	1.4	71	01121-00404	
	0.79	2.36					4.0				57	01121-00405
	1.57	3.18					4.8				51	01121-00406
	3.18	4.75					6.4				39	01121-00408
	4.75	6.35					7.9				32	01121-00410
	6.35	7.92					9.5				27	01121-00412
4.0 (5/32")	1.57	3.18	4.09	4.16	6.2	1.5	4.8	4.04	2.4	47	01121-00506	
	3.18	4.75					6.4				38	01121-00508
	4.75	6.35					7.9				31	01121-00510
	6.35	7.92					9.5				27	01121-00512
	7.92	9.52					11.1				23	01121-00514
	9.52	11.10					12.7				21	01121-00516
4.8 (3/16")	0.00	1.57	4.86	4.93	8.6	1.8	4.0	4.85	3.2	50	01121-00605	
	1.57	3.18					5.6				38	01121-00607
	3.18	4.75					7.2				33	01121-00609
	4.75	6.35					8.8				28	01121-00611
	6.35	7.92					10.0				24	01121-00613
	7.92	9.52					12.0				21	01121-00615
	9.52	11.10					13.5				19	01121-00617
	11.10	12.70					15.1				17	01121-00619
6.4 (1/4")	3.18	4.75	6.36	6.42	10.2	2.1	7.2	6.35	4.4	32	01121-00809	
	4.75	6.35					8.8				27	01121-00811
	6.35	7.92					10.0				24	01121-00813
	7.92	9.52					12.0				21	01121-00815
	9.52	11.10					13.5				19	01121-00817
	11.10	12.70					15.1				17	01121-00819

Authorised UK distributors for:

 Avdel southco

 BBA

 DEJOND

 GESIPA

 EJOT

# Chobert® 1143

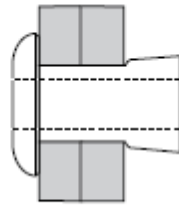
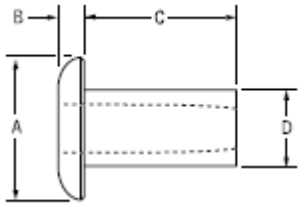



Dome head

Brass\*

Electro tin plated\*\*



ø					A	B	C	D		Fasteners per pod/ Nombre de rivets par chargeur / Niete pro Magazin/ Rivetti per carica- tore / Uds./carga	Part No/ref
	nom.	min.	max.	min.							
2.4 (3/32")	0.00	1.57	2.49	2.55	4.0	1.0	3.2	2.48	0.6	73	01143-00304
	1.57	3.17					4.8				
	3.17	4.75					6.4				
	4.75	6.35					8.0				
	6.35	7.92					9.6				
3.2 (1/8")	0.00	1.57	3.28	3.34	5.2	1.2	3.2	3.25	1.1	71	01143-00404
	1.57	3.17					4.8				
	3.17	4.75					6.4				
	4.75	6.35					8.0				
4.0 (5/32")	1.57	3.17	4.09	4.16	6.2	1.5	4.8	4.06	1.8	47	01143-00506
	3.17	4.75					6.4				
	4.75	6.35					8.0				
	6.35	7.92					9.6				
	7.92	9.52					11.1				
	9.52	11.10					12.7				
4.8 (3/16")	1.57	3.17	4.85	4.93	8.6	1.8	5.6	4.82	2.5	38	01143-00607
	3.17	4.75					7.2				
	4.75	6.35					8.8				
	6.35	7.92					10.4				
	7.92	9.52					12.0				
	9.52	11.10					13.5				

Authorised UK distributors for:

 Avdel southco

 BBA

 DEJOND

 GESIPA

 EJOT