

Avdel® Grovit®

The Avdel Grovit® Speed Fastening® system has been used since the sixties and has been continually developed by Avdel for blind hole applications in wood, plastics, fibreglass and aluminium. The Grovit rivet also has the flexibility to be used in harder substrates. The grooves on the Grovit rivet provide an increased pull out resistance.

Key features and benefits

- Annular grooves on the body expand radially during installation to provide a vibration resistant joint and increased pull-out resistance
- Suitable for blind hole applications
- Placed using a unique repetition mandrel system for high speed assembly

Grovit® 1103

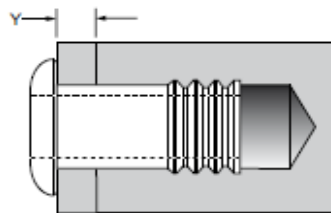
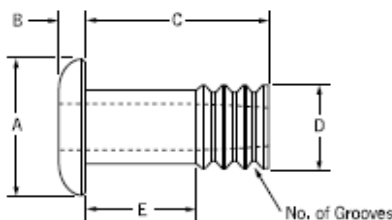

Dome head

Aluminium alloy*
(2.5 % Mg)
Natural

| Ø | Y | No. of Grooves | | A | B | C | D | E | No. of grooves/ cannelures/ Rillen / rigature / aros | kN ^D | Fasteners per pod/ Nombre de rivets par chargeur / Niete pro Magazin/ Rivetti per carica- tore / Uds./carga | Part No/ref |
|----------------|-----|----------------|------|-----|-----|------|------|-----|--|-----------------|--|-------------|
| | | min. | max. | | | | | | | | | |
| 2.4 (3/32") | 2.0 | 2.56 | 2.66 | 4.2 | 1.0 | 5.6 | 2.54 | 2.0 | 2 | 0.28 | 46 | 01103-00306 |
| 3.2 (1/8") | 3.6 | 3.45 | 3.53 | 5.6 | 1.2 | 8.8 | 3.43 | 3.2 | 3 | 0.50 | 32 | 01103-00410 |
| 4.0 (5/32") | 2.8 | 4.40 | 4.50 | 6.6 | 1.4 | 7.2 | 4.37 | 1.6 | 3 | 0.82 | 36 | 01103-00508 |
| | 5.2 | | | | | 11.9 | | 4.8 | 4 | | 22 | 01103-00514 |

Authorised UK distributors for:

Grovit® 1101

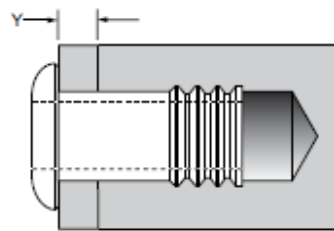
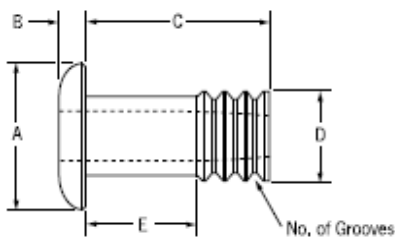

Dome head

Low carbon steel*

Zinc plated

Clear trivalent passivated

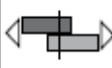
| ø | Y |  | | A | B | C | D | E | No. of grooves/ cannelures/ Rillen / rigature / aros |  | Fasteners per pod/ Nombre de rivets par chargeur / Niete pro Magazin/ Rivetti per carica- tore / Uds./carga | Part No/ref |
|----------------|-----|---|------|-----|-----|------|------|-----|--|--|--|-------------|
| | | nom. | max. | | | | | | | | | |
| 3.2 (1/8") | 3.6 | 3.45 | 3.55 | 5.6 | 1.0 | 8.8 | 3.43 | 3.2 | 3 | 1.2 | 32 | 01101-00410 |
| 4.0 (5/32") | 2.8 | 4.40 | 4.50 | 6.6 | 1.3 | 7.2 | 4.37 | 1.6 | 3 | 2.2 | 36 | 01101-00508 |
| | 4.4 | | | | | 10.4 | | 3.2 | 4 | | 25 | 01101-00512 |
| | 5.2 | | | | | 11.9 | | 4.8 | 4 | | 22 | 01101-00514 |

Authorised UK distributors for:

 Avdel southco®

 BBA
www.bbafasteners.com

 DEJOND

 GESIPA®

 EJOT®