

# Avdel® NeoSpeed®

Speed fasteners with a unique splined rivet design combining high clamp throughout a wide grip range. This newly developed fastening system has been designed and optimised using class-leading finite element analysis techniques, and its unique splined rivet design is patent pending.

## Key Features and Benefits

- The NeoSpeed® fastening process delivers a throughput up to four times greater than traditional threaded or breakstem fasteners
- Multi-grip capability accommodates wide variations in material thickness
- One rivet can be used to replace several standard grip fasteners
- External splines fill rear sheet and oversize front sheet holes
- 3x greater hole size tolerance than standard breakstem rivets
- Far less sensitive to application variations
- Easier specification due to one-rivet x one mandrel solution
- Typically half the installed weight versus an equivalent breakstem rivet



## Application

- Automotive
- Electronics
- Domestic appliances
- Electrical equipment
- General light fabrication



Authorised UK distributors for:

# NeoSpeed® 57121

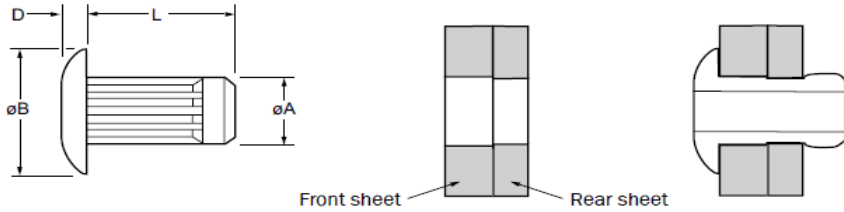

**Mushroom head**

Steel\*

Zinc plated

Clear trivalent passivated

ø	Front sheet / Pièce avant / oberes Bauteil / lamiera anteriore/ pieza delantera		Rear sheet / Pièce arriere / unteres Bauteil / lamiera posteriore/ pieza trasera		øB	D	L	øA			Part No/ref	
	min.	max.	min.	max.								max.
3.2* (1/8")	0.4	2.0	3.35	3.62	3.26	3.42	6.53	1.10	4.0	3.17	1.21	2.06
	0.4	4.5							6.5			
	0.4	8.6							10.7			
4.0* (5/32")	0.5	2.2	4.10	4.43	3.97	4.18	8.18	1.25	4.7	3.90	1.76	3.16
	0.5	5.0							7.5			
	0.5	9.1							11.7			
4.8 (3/16")	0.6	2.4	5.00	5.40	4.85	5.10	9.71	1.50	5.4	4.79	2.60	4.20
	0.6	5.2							8.2			
	0.6	9.2							12.4			

# NeoSpeed® 57101

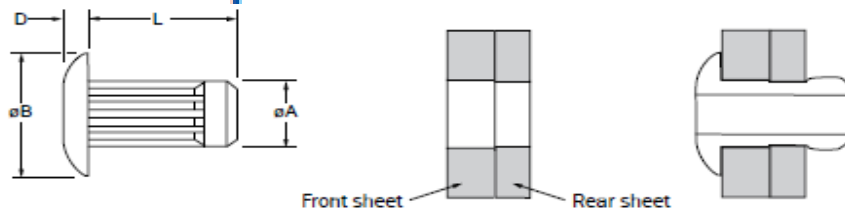

**Mushroom head**

Aluminium Alloy\*

(5% Mg)

Natural

ø	Front sheet / Pièce avant / oberes Bauteil / lamiera anteriore/ pieza delantera		Rear sheet / Pièce arriere / unteres Bauteil / lamiera posteriore/ pieza trasera		øB	D	L	øA			Part No/ref	
	min.	max.	min.	max.								max.
3.2* (1/8")	0.4	2.0	3.35	3.62	3.26	3.42	6.53	1.10	4.0	3.17	0.83	1.44
	0.4	4.5							6.5			
	0.4	8.6							10.7			
4.0* (5/32")	0.5	2.2	4.10	4.43	3.97	4.18	8.18	1.25	4.7	3.90	1.25	1.91
	0.5	5.0							7.5			
	0.5	9.1							11.7			
4.8 (3/16")	0.6	2.4	5.00	5.40	4.85	5.10	9.71	1.50	5.4	4.79	1.66	3.01
	0.6	5.2							8.2			
	0.6	9.2							12.4			

Authorised UK distributors for:

